

INSTALLATION INSTRUCTIONS

USA

FLIGHT

END CAP

ART. NO.	225 050g	gold
	225 050mc	matte chrome

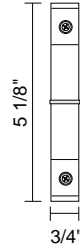

IMPORTANT SAFETY INSTRUCTIONS



1. SAVE THESE INSTRUCTIONS AND REFER TO THEM WHEN ADDITIONS TO OR CHANGES IN THE TRACK CONFIGURATION ARE MADE.
2. THIS PRODUCT MUST BE INSTALLED BY A PERSON FAMILIAR WITH THE CONSTRUCTION AND OPERATION OF THE PRODUCT AND THE HAZARDS INVOLVED, IN ACCORDANCE WITH LOCAL AND NATIONAL CODE.
3. Do not install this track in Damp or Wet locations.
4. Do not install any part of the track less than 7 feet above the floor.
5. Do not install any fixture assembly closer than 6 inches from any curtain, or similar combustibile material.
6. Turn off power prior to any work on the systems.
7. Do not attempt to energize anything other than lighting track fixtures specified for use with the FLIGHT system.
To reduce the risk of fire and electric shock, do not attempt to connect power tools, extension cords, appliances, and the like to the track.
8. This track system **MUST BE HARD WIRED**. For all the wire connections, use Listed Wire Nuts.
9. Total wattage of the system must never exceed 300W or wattage supplied by the low-voltage transformer.
10. Secondary connections must be clean and tight to avoid arcing and overheating!
11. Warranty is void in case of unauthorized modifications and/ or improper use.

READ ALL OF THESE INSTALLATION INSTRUCTIONS BEFORE INSTALLING THE SYSTEM

Contents of Delivery:
 End cap - qty. (1)

To install the Track End Cap onto FLIGHT track:

- Remove the allen screw (A) from the cover piece (B).
- The cover piece (B) will separate from the body of the end cap (C).
- With the upper and lower cover pieces removed, insert the ends of the FLIGHT track (D) into the grooves. Align the holes in the track to the two holes in the body of the end cap (C).
- Insert the allen screw (A) and cover piece (B) back into the body of the end cap (C).
- Tighten the allen screws.

FRONT VIEW

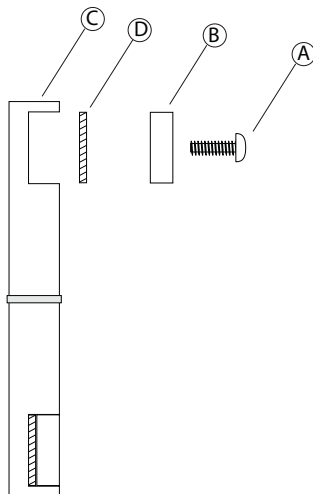

SIDE VIEW

